

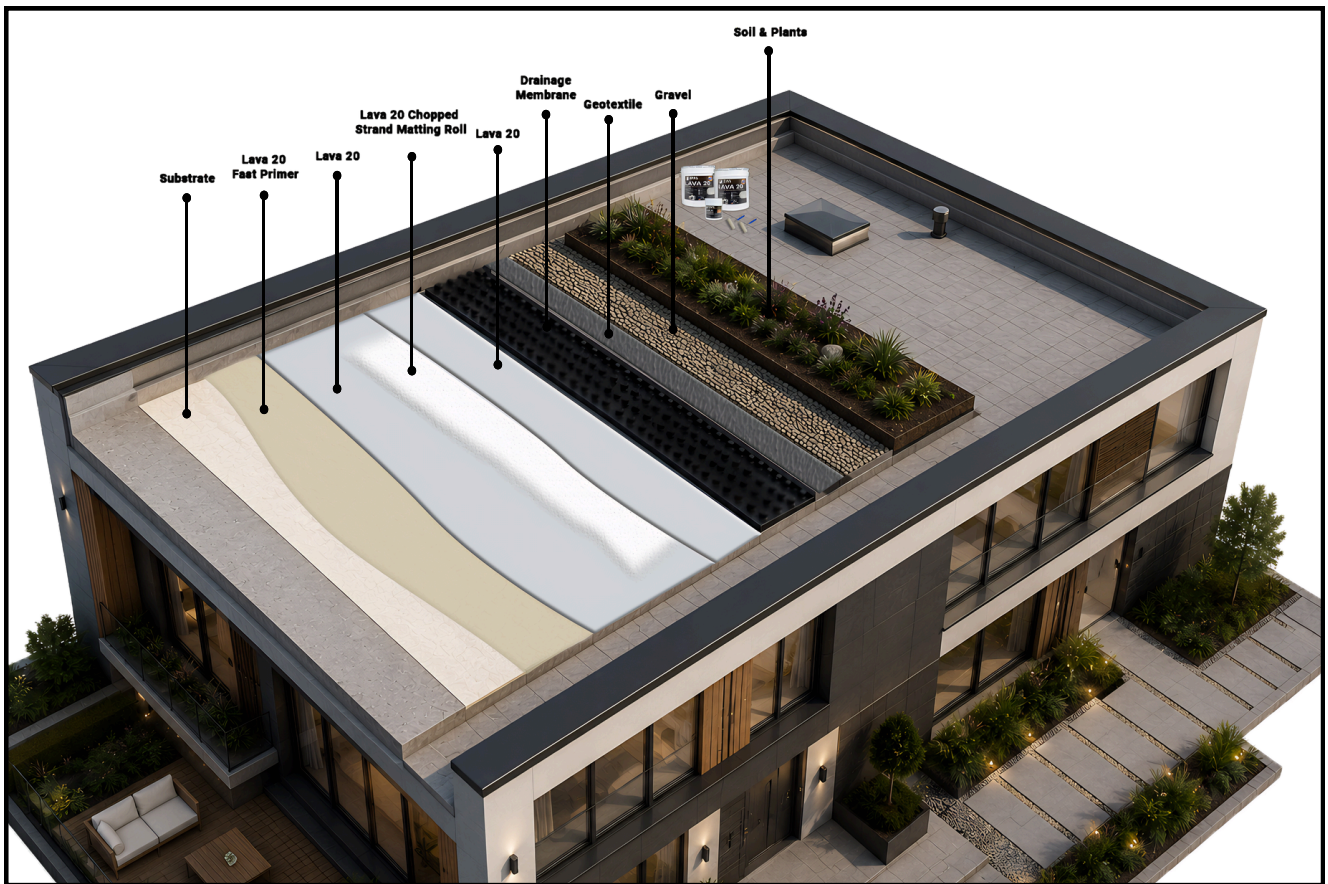

OWL WATERPROOFING

THE WISE CHOICE

GREEN ROOF BUILD UP WITH THE LAVA 20 SYSTEM





OWL WATERPROOFING

THE WISE CHOICE

RECOMMENDED BUILD-UP:

1. Prepare the substrate in accordance with the selected waterproofing membrane TDS.
 2. Prime the surface using a suitable primer depending on substrate and conditions (e.g. Lava 20 Fast Primer or Lava 20 2-Part Epoxy Primer for concrete).
 3. Apply the first coat of Lava 20.
 4. Reinforce with Lava 20 Chopped Strand Matting.
 5. Apply the second coat of Lava 20.
 6. Install the drainage membrane.
 7. Add protection fleece/chopped strand matting and gravel layer.
 8. Finish with soil and planting system.
-

NOTES:

- Recommended Lava 20 consumption for green roof applications: approx. **4.1 kg/m² (User Load P4)**. Adjust coat thickness and number of layers as required.
- Lava 20 Catalyst can be used to increase application thickness per coat and enable wet-on-wet application (refer to application guidelines).
- Ensure a minimum roof fall of **1.5–2%** to allow effective drainage and prevent ponding.
- Where insulation is required, install it beneath the waterproofing system (warm roof build-up). Additional separation layers, vapour control barriers, or ventilation may be required depending on the insulation type and project specification.

